

***Hydro-Hot***

**Beaver**

**Monterey**

**Patriot**

The information printed here reflects product design, fabrication, and component parts at the date of printing. The manufacturer reserves the right, at any time, to make changes in product design or material or component specifications as its sole option, without notice. This includes the substitution of components of a different brand or trade name, which will result in comparable performance. All information printed in this document is subject to change after the date of printing. Due to product improvements, changes during the model year and/or transcription errors that may occur, information represented within the owner's manual and/or this document may not be accurate at the time of your purchase. Please confirm any information with your dealer.

The following information is in addition to the information in the Beaver Owner's Manual in section 4. Please utilize the information provided henceforth.

©Monaco Coach Corporation. Beaver Motor Coach. All rights reserved. All other trademarks or registered trademarks are property of their respective holders. Brand name products of other companies mentioned in this addendum are not endorsed by Monaco Coach Corporation.

## Hydro-Hot:

Information for the Hydro-Hot in section four of the owner's manual needs to be updated to reflect the following changes:

### General Layout:

An understanding of the general layout of the Hydro-Hot system will help in operating and troubleshooting the system.

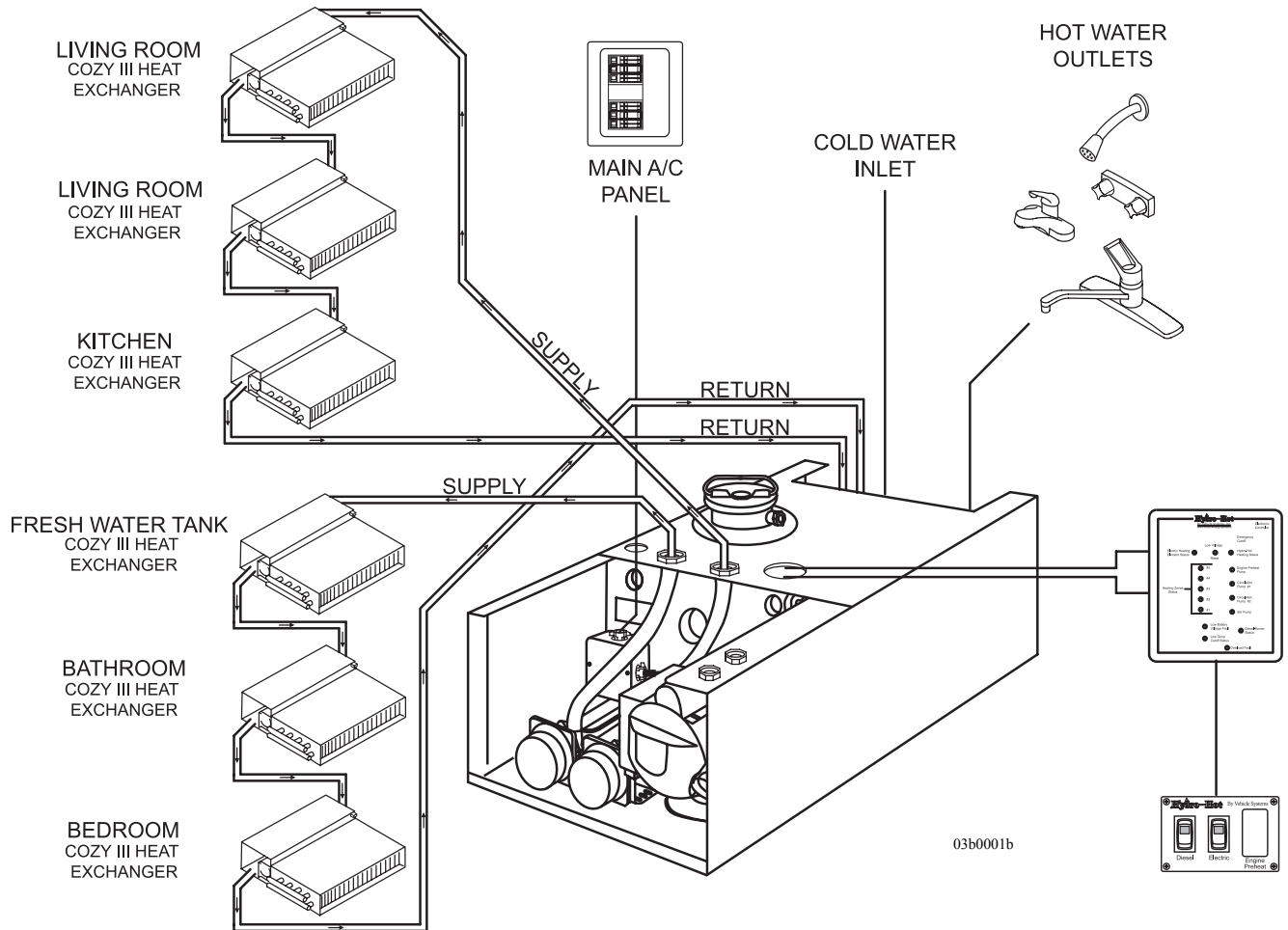

Once the Main Disconnect and interior house power switches are turned ON, the Hydro-Hot system is ready for use. The Hydro-Hot system requires a liquid to be in the tank. This can be either potable water or RV antifreeze. Located in the living room/kitchen area is the switch panel to operate the heating sources of the Hydro-Hot.

## Troubleshooting:

Once the operating conditions are met and a heating source selected and the Hydro-Hot doesn't appear to be working there are some quick checks that can be made to determine the problem. Located in a passenger side compartment along with the Hydro-Hot unit is the electronic controller. Depending on the floor plan this can be a hard panel to view straight on and an indication may go overlooked. A quick glance of the panel can show where the fault is located. Any RED light indicates a fault conditions. Understanding the light indications and what they mean is important to diagnosing the system.

The most critical lamp would be the Heating Status. When this lamp is off NO heat is being supplied to the heat tank. A GREEN indication means one or both of the heat sources are heating the tank. The heating element indicator is GREEN whenever AC Power is being supplied. A RED lamp here indicates an overload or a short circuit condition in the DC powered electrical circuits. A service technician should investigate this.

The Emergency Cutoff lamp indicates one of two things, there is a low liquid level in the heat tank or there was a strong impact to the unit. Whenever this occurs the electronic controller must be manually reset. If the power has been disconnected for an extended period of time this may generate an Emergency Cutoff indication. Again this would require the electronic controller to be manually reset. This condition could be related to a Low Battery Voltage Fault. If 12 Volt DC drops below 10.5 Volt DC the system will not operate. Once proper operating voltage is restored a Low Battery Voltage Fault will reset automatically. Remember; look to see if an Emergency Cutoff fault was generated.

Another indicator that is probably the most misunderstood indication of all is the Low Temperature Cutoff Status. A GREEN indication means heat is available for interior heat. When this lamp is OFF, a continuous demand for domestic hot water is being used. The Hydro-Hot uses the "Domestic Water Priority System". It cannot supply both interior heat and a continuous supply of hot water simultaneously. Heat will only be available once the demand ceases.

Heating the interior of the motorhome requires the comfort control to be turned on and set to furnace. When there is a call for heat the system will activate the circulation pumps only after ensuring there is no demand for domestic hot water. If there is no demand for water only then will interior heating be available. When heating is available the fan speed selector switches will have power applied to them and will be audible when turned ON.

Additional troubleshooting information can be obtained by contacting Vehicle System's Service Department at 1-800-685-4298 or visiting their website [www.hydro-hot.com](http://www.hydro-hot.com).

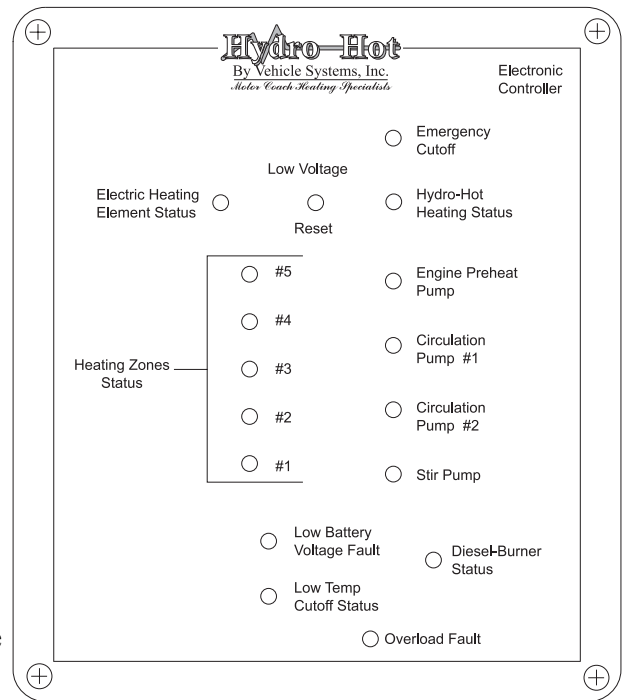

040486



**Beaver Motor Coach**

P.O. Box 5639

Bend, OR 97708

[www.beavermotorcoach.com](http://www.beavermotorcoach.com)

**Warranty/Technical Support**

Toll Free 800-344-6332